

No.100

스탠다드급 NRB 차륜

UCHIMURA



회전형

- [본체 재질]**
냉간압연강판(SPCC)
- [표면 처리]**
전기아연도금(광택크로메이트)
- [차륜 재질]**
니트릴부타젠 고무(NBR)

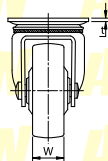
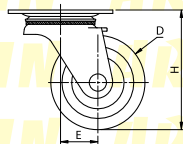
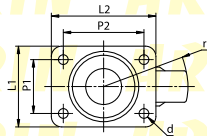

형식	차륜경 (D)	차륜폭 (W)	선회반경 (r)	편심거리 (E)	차륜취부높이 (H)	상판치수 (L1×L2)	취부피치 (P1×P2)	취부구멍 (d)	상판두께 (t)	허용하중 (kg/1개)
NO.102	40	17	39	19	55	37×54	26×45	4.5	2	40
NO.103	50	20	44	19	65	42×60	29×47	6.5		50
NO.104			45	20	67					55
NO.105	63	21	57	25	80	54×70	36×54		8.5	2.3
NO.106	75		63		93			65		
NO.107	100	22	83	33	123	75×99	56×80	2.9		4
NO.108	130	25	101	36	150				95	
NO.109	155	28	122	44	190	90×125	67×103		10.5	4
NO.111	200	32	153	53	236		67×102	13	100	