

# No.100PR

## 스탠다드급 PBR 차륜

UCHIMURA



회전형

**【본체 재질】**

냉간압연강판(SPCC)

**【표면 처리】**

전기아연도금(광택크로메이트)

**【차륜 재질】**

폴리부타젠 고무(PBR)

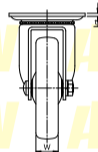
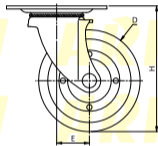
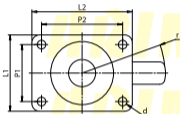

형식	차륜경 (D)	차륜폭 (W)	선회반경 (r)	편심거리 (E)	차륜취부높이 (H)	상판치수 (L1×L2)	취부피치 (P1×P2)	취부구멍 (d)	상판두께 (t)	허용하중 (kg/1개)
NO.107PR	100	22	83	33	123	75×99	56×80	8.5	2.9	85
NO.108PR	130	25	101	36	150					95
NO.109PR	150	28	119	44	188	90×125	67×103	10.5	4	120
NO.111PR	200	32	153	53	236					67×102