

No.600PR

스탠다드급 PRB 차륜

UCHIMURA



고정형

【본체 재질】

냉간압연강판(SPCC)

【표면 처리】

전기아연도금(광택크로메이트)

【차륜 재질】

폴리부타젠고무(PBR)

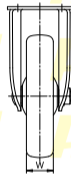
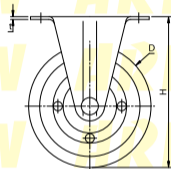
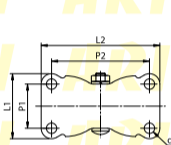

형식	차륜경 (D)	차륜폭 (W)	차륜취부높이 (H)	상판폭 (L1)	상판길이 (L2)	취부피치 (P1×P2)	취부구멍 (d)	상판두께 (t)	허용하중 (kg/1개)
NO.607PR	100	22	123	53	97	36×80	8.5	2.3	85
NO.608PR	130	25	150						95
NO.609PR	150	28	188	72	123	52×103	10.5	2.9	120
NO.611PR	200	32	236	78	136	52×110	13		100