

No.100-FE

스탠다드급 강철제 차륜



회전형

【본체 재질】

냉간압연강판(SPCC)

【표면 처리】

전기아연도금(광택크로메이트)

【차륜 재질】

냉간압연강판(SPCC)

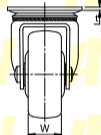
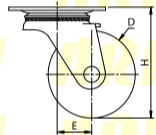
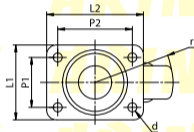

UCHIMURA

형식	차륜경 (D)	차륜폭 (W)	선회반경 (r)	편심거리 (E)	차륜취부높이 (H)	상판치수 (L1×L2)	취부피치 (P1×P2)	취부구멍 (d)	상판두께 (t)	허용하중 (kg/1개)
NO.102-FE	40	17	39	19	55	37×54	26×45	4.5	2	80
NO.103-FE	51	20	45		66	42×60	29×47	6.5		100
NO.105-FE	63	24	57	25	80	54×70	36×54		2.3	150