

No.100HB₂-PA

헤비급 래디얼베어링 폴리우레탄 차륜

UCHIMURA



- 【본체 재질】
냉간압연강판(SPCC)
- 【표면 처리】
검정색아연도금
- 【차륜 재질】
폴리우레탄(PA)

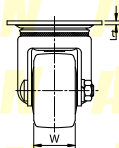
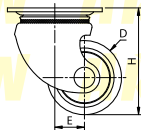
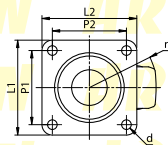

회전형

형식	차륜경 (D)	차륜폭 (W)	선회반경 (r)	편심거리 (E)	차륜취부높이 (H)	상판치수 (L1×L2)	취부피치 (P1×P2)	취부구멍 (d)	상판두께 (t)	허용하중 (kg/1개)
NO.102HB ₂ -PA	40	25	35	14	60	58×58	44×44	6.5	2.3	200
NO.104HB ₂ -PA	50	28	46	20	72	64×64	50×50		2.6	250