

No.100HB₂-EPS

헤비급 래디얼베어링 엔프라 차륜



회전형, 스톱퍼

【본체 재질】
 냉간압연강판(SGCC)
【표면 처리】
 검정색아연도금
【차륜 재질】
 특수폴리머컴파운드(EP)

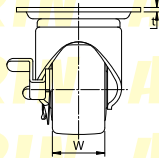
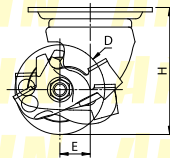
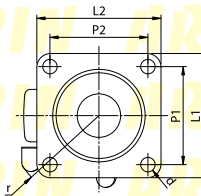

UCHIMURA

형 식	차륜경 (D)	차륜폭 (W)	선회반경 (r)	편심거리 (E)	차륜취부높이 (H)	상판치수 (L1×L2)	취부피치 (P1×P2)	취부구멍 (d)	상판두께 (t)	허용하중 (kg/1개)
NO.105HB ₂ -EPS	65	38	66	22	92	90×90	71×71	10.5	3.2	300
NO.106HB ₂ -EPS	75	38	68	22	106	90×90		10.5	3.2	350