

No.100E

정전기방지 NRB 차륜



회전형

- [본체 재질]**
냉간압연강판(SPCC)
- [표면 처리]**
전기아연도금(광택크로메이트)
- [차륜 재질]**
니트릴부타젠 고무(NBR)

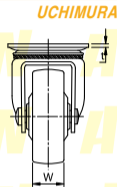
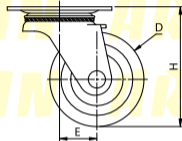
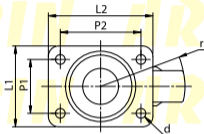

형식	차륜경 (D)	차륜폭 (W)	선회반경 (r)	편심거리 (E)	차륜취부높이 (H)	상판치수 (L1×L2)	취부피치 (P1×P2)	취부구멍 (d)	상판두께 (t)	허용하중 (kg/1개)
NO.103E	50	20	44	19	65	42×60	29×47	6.5	2	25
NO.104E			45	20	67					35
NO.105E	63	21	57	25	80	54×70	36×54			2.3
NO.106E	75		63		93			50		
NO.107E	100	22	83	33	123	75×99	56×80	8.5	2.9	50
NO.108E	130	25	101	36	150					90
NO.109E	155	28	122	44	190	90×125	67×103	10.5	4	100