

SUS-SK

스테인레스 차륜

YUEI



[본체 재질]
스테인레스(SUS304)
[특징]
내식성, 내수성에 뛰어남

고정형

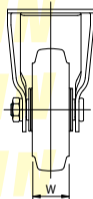
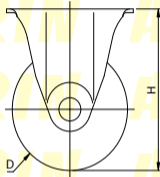
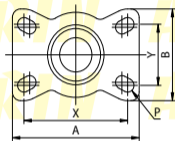

형식	차륜재질	차륜경 (D)	차륜폭 (W)	취부높이 (H)	상판치수 (A×B)	취부피치 (X×Y)	취부구멍 (P)	허용하중 (kgf)	질량(g)
SUS-SK-100	NR	100	32	132	110×75	90×50 (80×45)	11	102	670
	N								520
	NB								620
	GU								710
SUS-SK-125	GU	125		168	135×94	112×56(100×53)	122	1030	